

# AIRLOCK-S

HSKHKM

---

## Features & Advantages

---

The Airlock-S is used in pneumatic conveying lines, mainly with bag filters and cyclone separators. It works under negative pressure and provides an air seal against product leakage.

Two options are available to choose from;

- Flange mounted gearmotor
  - Coupled shaft gearmotor
- 



**HENRY SIMON**  
MANCHESTER 1878

↓ Front View

↓ Side View

↓ Side View

↓ Top View

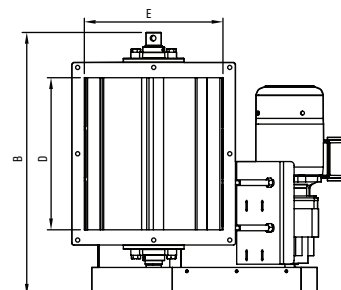
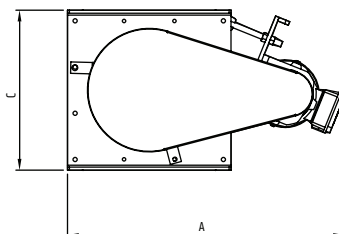
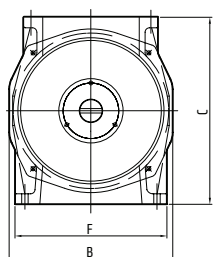
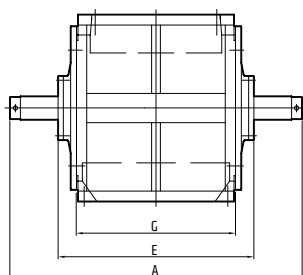

HSKHKM - Airlock (Cast Iron)

HSSHKM - Airlock (Sheet Metal)

### Technical Features

Model	Capacity (TPH)			Weight (Kg)		Gross Volume (m <sup>3</sup> )
	Wheat	Flour	Bran	Net	Gross	
HSKHKM - 25 / 21	6.04	4.35	2.41	56.5	81	0.1
HSKHKM - 25 / 27	8.42	6.06	3.37	61	88	
HSKHKM - 25 / 33	10.76	7.75	4.30	75.5	104	

### Technical Features

Model	Weight (Kg)		Gross Volume (m <sup>3</sup> )
	Net	Gross	
HSSHKM - 22 / 27	56	81	0.3
HSSHKM - 25 / 33	61	95	0.4
HSSHKM - 35 / 40	66	104	0.5
HSSHKM - 45 / 45	72	110	0.9
HSSHKM - 50 / 50	90	125	1.1
HSSHKM - 60 / 60	100	135	1.5

### Dimensions (mm)

Model	A	B	C	E	F	G
HSKHKM - 25 / 21	368	280	320	275	260	210
HSKHKM - 25 / 27	430			337		272
HSKHKM - 25 / 33	490			398		333

### Dimensions (mm)

Model	A	B	C	D	E
HSSHKM - 22 / 27	330	670	320	270	263
HSSHKM - 25 / 33	550	700	320	330	263
HSSHKM - 35 / 40	430	820	420	400	365
HSSHKM - 45 / 45	800	800	525	450	465
HSSHKM - 50 / 50	1,000	850	550	500	513
HSSHKM - 60 / 60	1,000	950	650	600	613

\*Henry Simon reserves the right to change, delete, or otherwise modify the information which is represented without any prior notice.